



MBR0580S1

0.5A SURFACE MOUNT SCHOTTKY BARRIER RECTIFIER

Product Summary

V _{RRM} (V)	I _O (A)	V _{F(MAX)} (V) @ +25°C	I _{R(MAX)} (μA) @ +25°C
80	0.5	0.80	5

Description and Applications

This MBR0580S1 is a single rectifier packaged in SOD123. Ideally suited for low voltage, high frequency rectification or as free-wheeling and polarity protection diodes in surface mount applications where compact size and weight are critical to the system. Typical applications are AC-DC and DC-DC converters, reverse battery protection, and “O-ring” of multiple supply voltages and any other application where performance and size are critical.

Features and Benefits

- Low Forward Voltage (V_F) Minimizes Conduction Losses and Improves Efficiency
- Guard Ring Die Construction for Transient Protection
- **Totally Lead-Free & Fully RoHS Compliant (Notes 1 & 2)**
- **Halogen and Antimony Free. “Green” Device (Note 3)**

Mechanical Data

- Case: SOD123
- Case Material: Molded Plastic, “Green” Molding Compound; UL Flammability Classification Rating 94V-0
- Moisture Sensitivity: Level 1 per J-STD-020
- Terminals: Matte Tin Finish Annealed over Copper Leadframe. Solderable per MIL-STD-202, Method 208
- Polarity: Cathode Band
- Weight: 0.01 grams (Approximate)

SOD123



Top View

Ordering Information (Note 4)

Part Number	Case	Packaging
MBR0580S1-7	SOD123	3,000/Tape & Reel

Marking Information

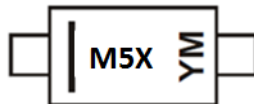

M5X = Product Type Marking Code
 YM = Date Code Marking
 Y = Year (ex.: E = 2017)
 M = Month (ex: 9 = September)

Date Code Key

Year	2014	2015	2016	2017	2018	2019	2020	2021
Code	B	C	D	E	F	G	H	I

Month	Jan	Feb	Mar	Apr	May	Jun	Jul	Aug	Sep	Oct	Nov	Dec
Code	1	2	3	4	5	6	7	8	9	O	N	D

Maximum Ratings (@T_A = +25°C, unless otherwise specified.)

Single phase, half wave, 60Hz, resistive or inductive load.
For capacitive load, derate current by 20%.

Characteristic	Symbol	Value	Unit
Peak Repetitive Reverse Voltage Working Peak Reverse Voltage DC Blocking Voltage	V _{RRM} V _{RWM} V _{RM}	80	V
RMS Reverse Voltage	V _{R(RMS)}	56	V
Average Rectified Output Current	I _O	0.5	A
Non-Repetitive Peak Forward Surge Current 8.3ms Single Half Sine-Wave Superimposed on Rated Load	I _{FSM}	14	A

Thermal Characteristics

Characteristic	Symbol	Value	Unit
Typical Thermal Resistance Junction to Ambient (Note 5)	R _{θJA}	354	°C/W
Typical Thermal Resistance Junction to Ambient (Note 6)	R _{θJA}	200	°C/W
Typical Thermal Resistance Junction to Case (Note 5)	R _{θJC}	80	°C/W
Typical Thermal Resistance Junction to Case (Note 6)	R _{θJC}	70	°C/W
Operating Temperature Range	T _J	-55 to +175	°C
Storage Temperature Range	T _{STG}	-55 to +150	°C

Electrical Characteristics (@T_A = +25°C, unless otherwise specified.)

Characteristic	Symbol	Min	Typ	Max	Unit	Test Condition
Reverse Breakdown Voltage (Note 7)	V _(BR)	80	—	—	V	I _R = 1.0mA
Forward Voltage Drop	V _F	—	0.69 0.56	0.80 —	V	I _F = 0.5A, T _A = +25°C I _F = 0.5A, T _A = +125°C
Leakage Current (Note 7)	I _R	—	0.5 280	5 —	μA	V _R = 80V, T _A = +25°C V _R = 80V, T _A = +125°C
Total Capacitance	C _T	—	15	—	pF	V _R = 5V, f = 1.0MHz

Notes: 5. Device mounted on FR-4 substrate, 2 oz. copper, minimum recommended pad layout per <http://www.diodes.com/package-outlines.html>.
6. Device mounted on FR-4 substrate, 2 oz. copper, 1inch square Cu pad.
7. Short duration pulse test used to minimize self-heating effect.

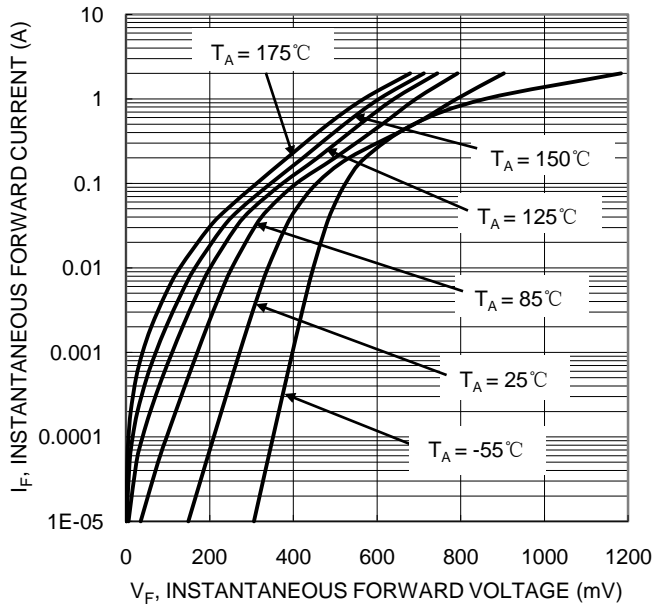

Figure 1. Typical Forward Characteristics

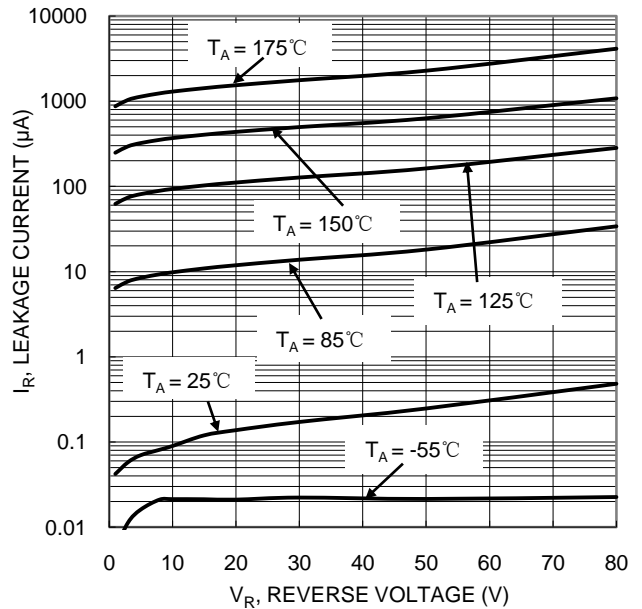

Figure 2. Typical Reverse Characteristics

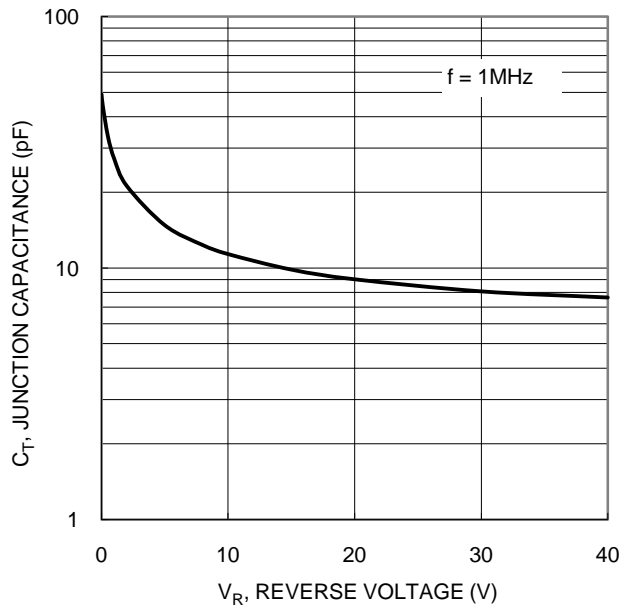

Figure 3. Typical Junction Capacitance

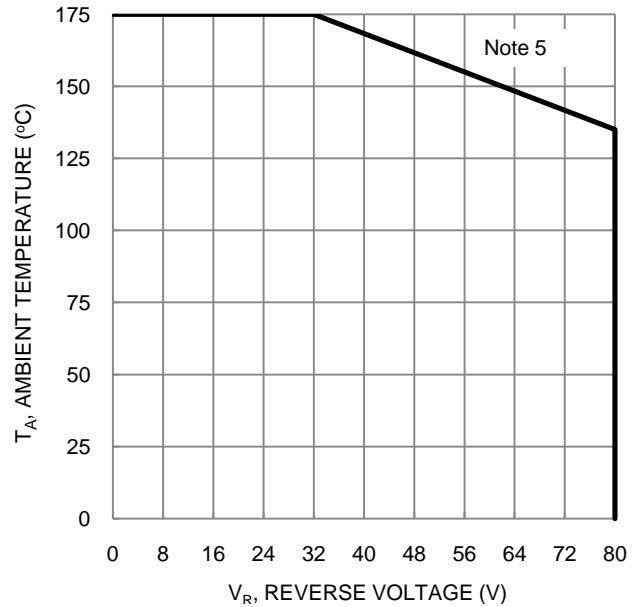

Figure 4. Operating Temperature Derating

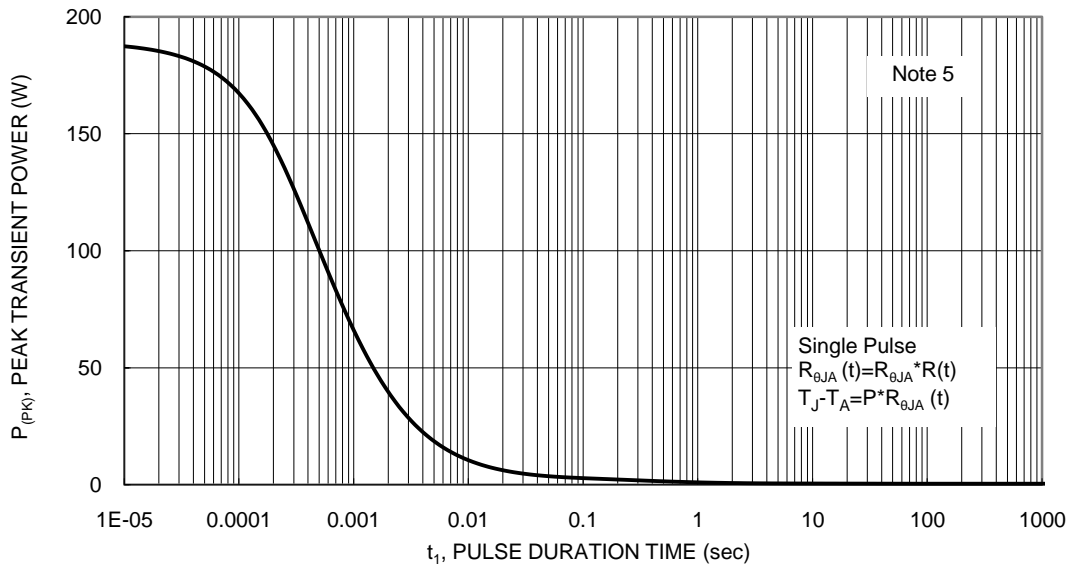

Figure 5. Single Pulse Maximum Power Dissipation

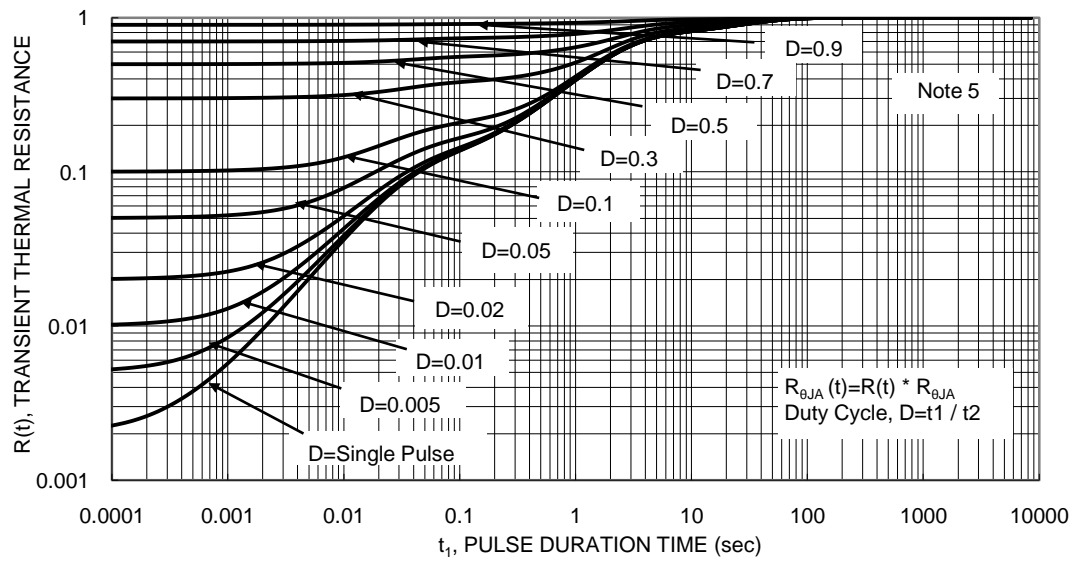
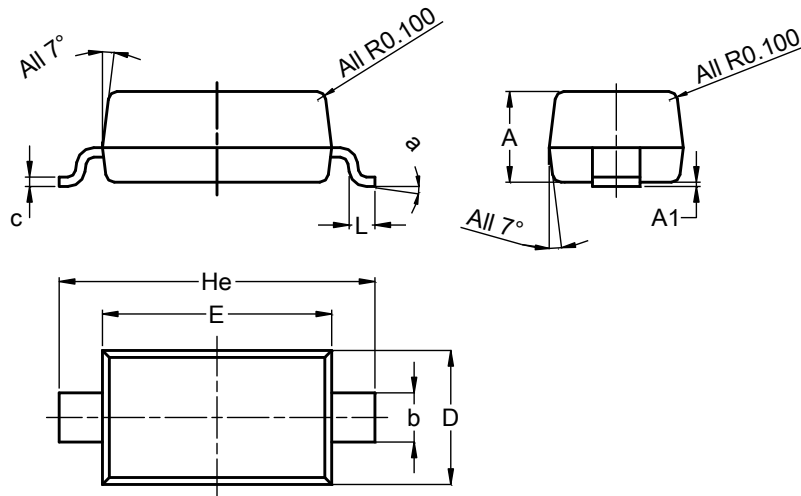

Figure 6. Transient Thermal Resistance

Package Outline Dimensions

Please see <http://www.diodes.com/package-outlines.html> for the latest version.

SOD123



SOD123			
Dim	Min	Max	Typ
A	1.00	1.35	1.05
A1	0.00	0.10	0.05
b	0.52	0.62	0.57
c	0.10	0.15	0.11
D	1.40	1.70	1.55
E	2.55	2.85	2.65
He	3.55	3.85	3.65
L	0.25	0.40	0.30
a	0°	8°	--
All Dimensions in mm			

Suggested Pad Layout

Please see <http://www.diodes.com/package-outlines.html> for the latest version.

SOD123

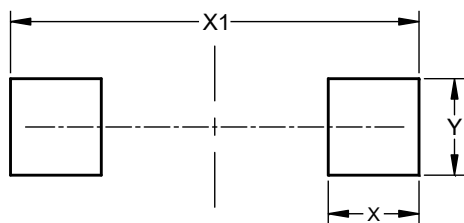

Dimensions	Value (in mm)
X	0.900
X1	4.050
Y	0.950